

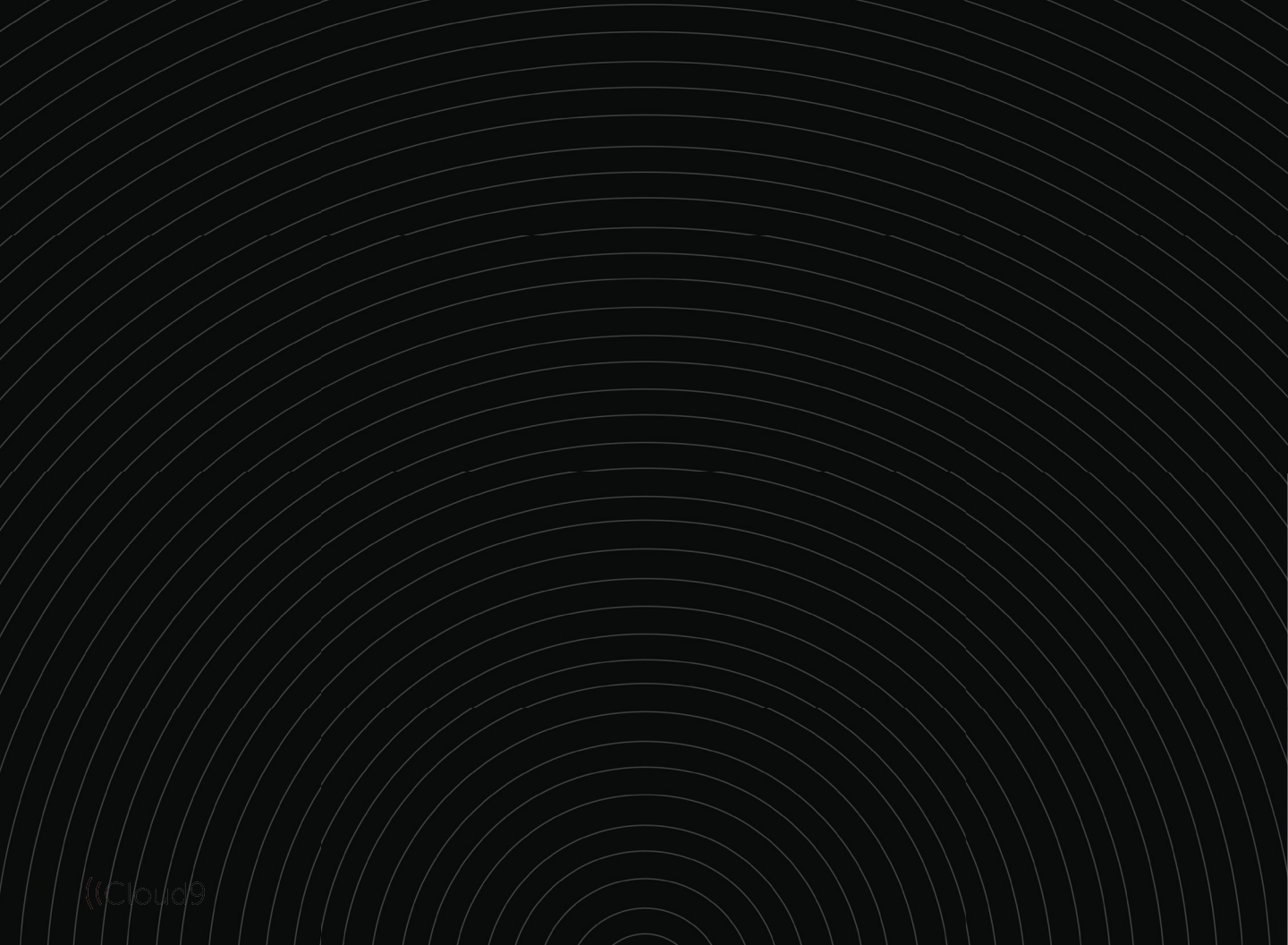

# Welcome to your **NEW Cloud9 CloudHub**



Let's set up your new hardware.



CLOUDHUB OVERVIEW..... 4

POWER SUPPLY INSTALLATION..... 6

CLOUD9 HANDSET INSTALLATION..... 8

CLOUD9 MICROPHONE INSTALLATION..... 10

CONNECTING CLOUDHUB TO A PC OR LAPTOP..... 12

## CLOUDHUB OVERVIEW

CloudHub Front View



CloudHub Rear View



CloudHub Underside View



**Your Cloud9 CloudHub is supplied with:**

- 1 X AC Power Supply
- 1 X Power Cord
- 1 X USB-C to USB-A 2M Cable (*This is for connecting your CloudHub to your Windows-based PC/Laptop*)

**Optional Extras for your CloudHub are:**

- Cloud9 Gooseneck Microphone
- Cloud9 Handset PTT or PTM (*With built-in Toggle Switch and Volume Roller*)

## POWER SUPPLY INSTALLATION



1. Install the power supply connector (see *Diagram A*) into the Cloud9 **CloudHub** Power Supply Input.



*Diagram A*

2. Install the **Power Cord** (see *Diagram C*) into the **AC Power Supply** (see *Diagram B*) for your Cloud9 **CloudHub** and connect your **Power Cord** to the mains power socket.



*Diagram B*



*Diagram C*

## CLOUD9 HANDSET INSTALLATION

Cloud9 Handset



Cloud9 CloudHub Underside

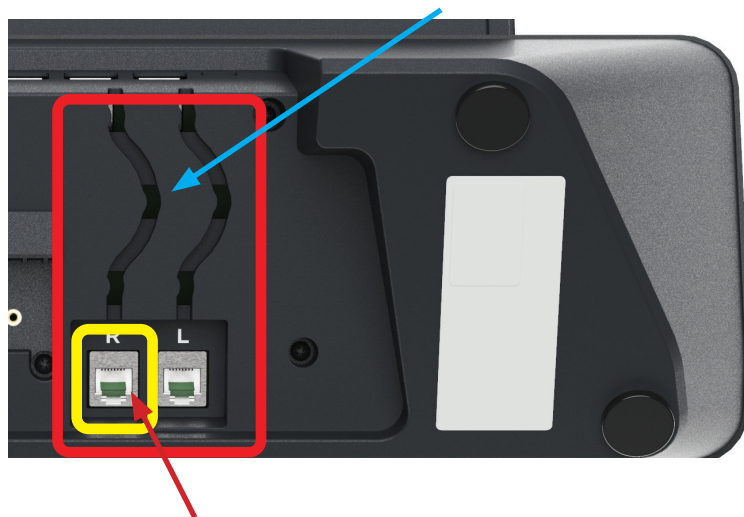

Diagram A

1. Install the Cloud9 Handset(s) RJ11 Connector (see Diagram B) into the RJ11 socket located on the Cloud9 **CloudHub** underside and run the cable through the cable channel to ensure the cable(s) are kept tidy and secure (highlighted by the blue arrow in Diagram A).

The handset socket highlighted in yellow in the left diagram is the socket for your "Right Handset" and the second RJ11 socket is for your "Left Handset" if a secondary handset is required (see Diagram C).

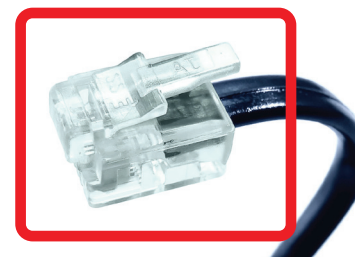

Diagram B



R = Right Handset  
L = Left Handset

Diagram C



## CLOUD9 MICROPHONE INSTALLATION

### Cloud9 Microphone



### Cloud9 CloudHub Underside

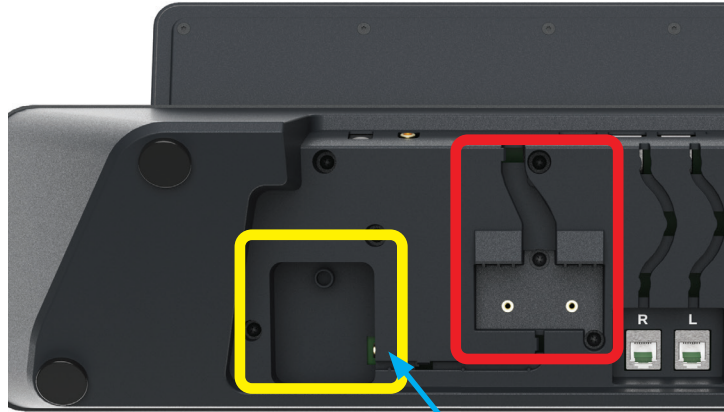

Diagram A

1. Your Cloud9 **CloudHub Microphone** is supplied pre-assembled but requires mounting to the **CloudHub Underside** and the Microphone input plugging into the input jack (*highlighted by the blue arrow in Diagram A*).
2. Place the Cloud9 **CloudHub** Microphone bracket over the two captive nuts highlighted by the red box, with the gooseneck routed through the channel upwards (*see Diagram B*).

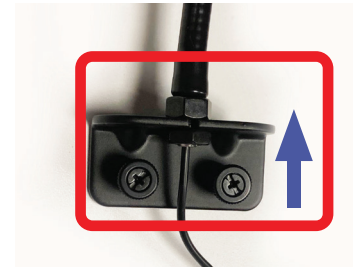

Diagram B

3. With your gooseneck routed upwards, tighten the 2 X Thumb Screws to secure the bracket onto the Cloud9 **CloudHub**.
4. Once the bracket is secure, run the Microphone cable through the channel and connect the Microphone Jack (*highlighted by the blue arrow in Diagram A*).

## CONNECTING CLOUDHUB TO A PC OR LAPTOP

1. Connect the USB-C end of your supplied USB-C to USB-A cable (see *Diagram B*) into the USB-C slot on your Cloud9 **CloudHub** (highlighted by the red square in *Diagram A*).



Diagram A



Diagram B

2. Connect the USB-A end of your supplied USB-C to USB-A cable (see *Diagram C*) into a spare USB slot on your **Microsoft Windows**-based PC or Laptop (see *Diagram D & Diagram E*).



Diagram C



Diagram D – Laptop Example



Diagram E – PC Example

3. Upon successful installation of your Cloud9 **CloudHub**, and once you have launched and logged into C9 Trader, you will be ready to use your new Cloud9 **CloudHub**.



Enjoy your new  
Cloud9 CloudHub.



©Cloud9 Technologies 2020  
All rights reserved.





Access video tutorials, product guides and more at [C9tec.com](https://c9tec.com)